

SUSPENSION — FRONT — From Series IV

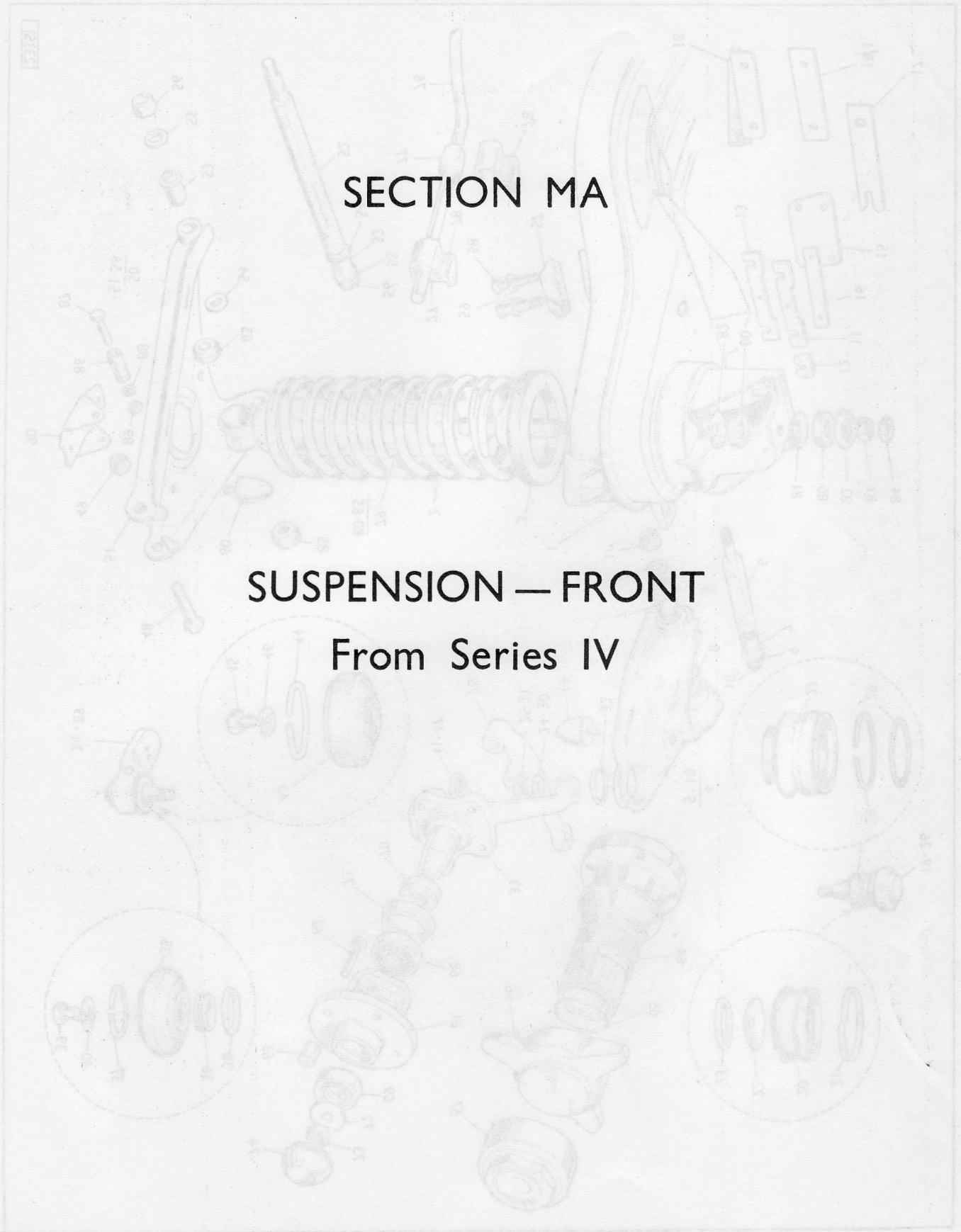

# SECTION MA

## SUSPENSION — FRONT

From Series IV

SECTION MA

# SUSPENSION — FRONT — From Series IV

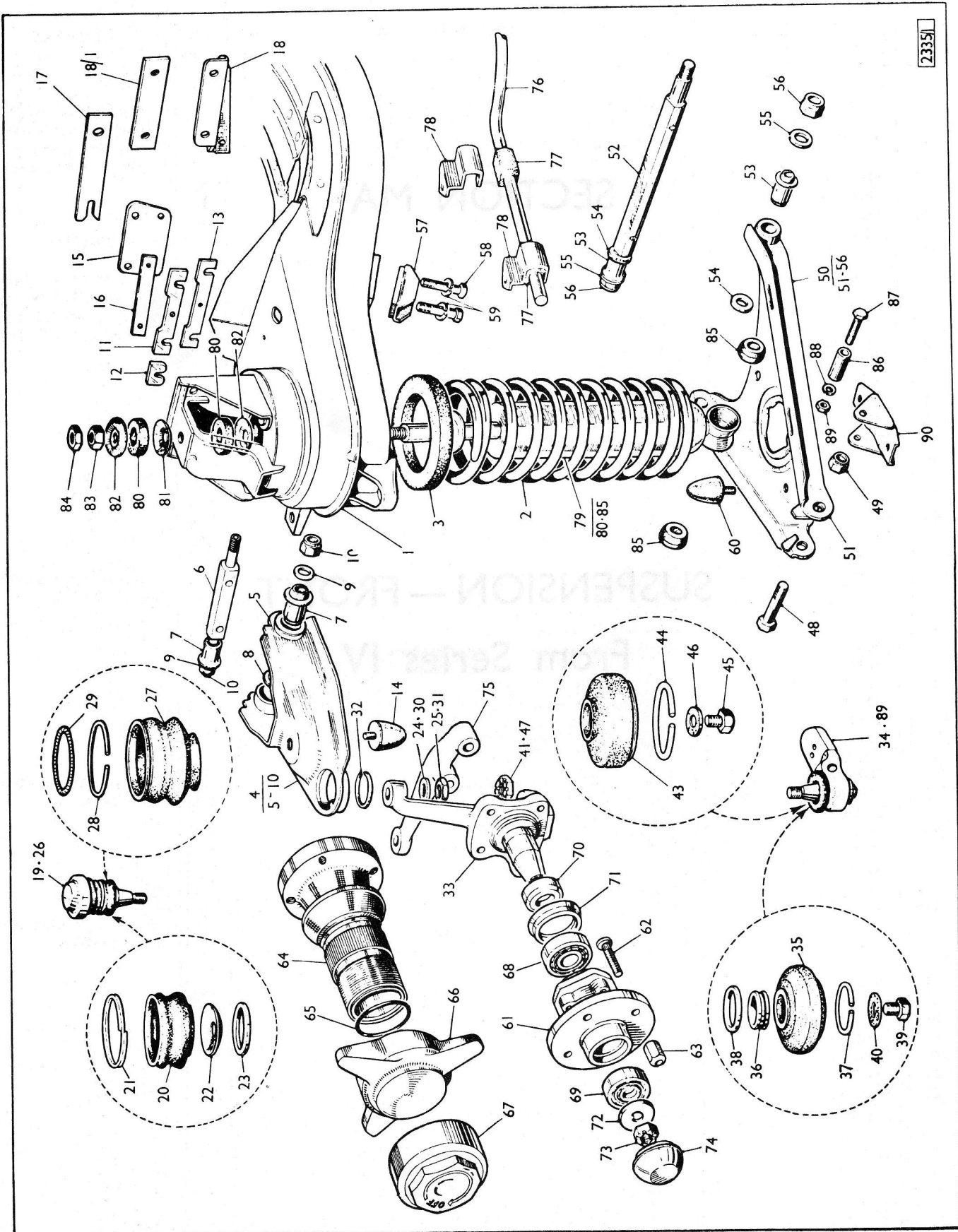

23351

## SECTION MA

3rd Issue

SUSPENSION — FRONT — From Series IV

Plate Ref.	Part Number	DESCRIPTION	No. per Veh.	REMARKS
	1206377	FRONT SUSPENSION CROSSMEMBER	1	Up to B9403517 Std. Wheels
1	1219407	†FRONT SUSPENSION CROSSMEMBER	1	B9403767 Knock-on Wheels From B9403518 Std. Wheels B9403768 W/W; See Note †
	9003223	Bolt, ½" UNF. × 3¼"	4	} Front suspension crossmember
	9664322	Washer, ½" shakeproof	4	
	9067509	Washer, ½" plain	4	
	1224603	Taper wedge	1	} to frame
2	1206763	COIL SPRING	2	
	P.108521	Insulator	2	} Coil
	P.108521	Insulator		
3		Coil	2	} spring
	P.108521	Insulator		
4	5220770	UPPER LINK c/w Fulcrum Pin and Bushes	2	} Up to B94103462 Std. and GT and B9473386 "260"
5		Upper link (Not supplied separately)	2	
6	1224225	Fulcrum pin	2	} Upper link
7	5220478	Bush		
8	1205949	Washer, Special (Inner)	4	} Fulcrum pin
9	9067426	Washer, ½" plain (Outer)	4	
10	9571083	Nut, ½" UNF. (Nyloc)	4	} to bush
	9553083	Nut, ½" UNF. (Philidas type)	4	
11	P.83576	Shim, long, .064"	A/R	} Upper fulcrum pin
12	P.109696	Shim, short, .015"		
13	1214491	Shim, .104"	A/R	} crossmember
	19107143	Bolt, ⅞" UNF. × 1¼"	4	
	19107163	Bolt, ⅞" UNF. × 2"	4	} Top bracket and upper link
	19107153	Bolt, ⅞" UNF. × 1⅞"	4	
	9664282	Washer, ⅞" shakeproof	4	} Alternatives
14	1214933	REBOUND RUBBER	2	
	9664242	Washer, ⅜" shakeproof	2	} Rebound rubber
	5220703	Nut, ⅜" UNF.	2	
15	1201440	TOP BRACKET, O/S (R.H.)	1	} to upper links
	1201441	TOP BRACKET, N/S (L.H.)	1	
	19506113	Screw, ⅜" UNF. × 1⅜"	2	} Top bracket to tie bracket
	19506143	Screw, ⅜" UNF. × 1⅜"	2	
16	9090038	Lock plate	2	} Tie bracket
	9067256	Washer, ⅜" plain	4	
17	P.116809	Shim, .064" thick	A/R	} Tie bracket
	P.116810	Shim, .020" thick	A/R	
18	P.113548	TIE BRACKET, O/S (R.H.)	1	} Tie bracket
	P.113549	TIE BRACKET, N/S (L.H.)	1	
	19106203	Bolt, ⅜" UNF. × 2½"	4	} Tie bracket
	9664242	Washer, ⅜" shakeproof	4	
18/1	1215427	†ATTACHMENT BRACKET	2	} Upper fulcrum pin
	19107143	†Bolt, ⅞" UNF. × 1¼"	4	
	9664282	†Washer, ⅞" shakeproof	4	} to crossmember
		Note. Items † also fitted to B9403245, 6, 7, 8, B9403271, B9403273		
19	5220424	*SWIVEL BEARING—Top	2	} Swivel bearing
20	5038863	Boot	2	
21	5040876	Spring clip	2	} Boot
22	5038865	Retainer	2	
23	9067453	Washer	2	} Swivel bearing
24	9067056	Washer, ½" plain	2	
25	9552083	Nut, ½" UNF. Nyloc	2	} to axle carrier
		*Note. It is important that the correct boot and fixings are ordered, check illustrations.		

SUSPENSION — FRONT — From Series IV

Plate Ref.	Part Number	DESCRIPTION	No. per Veh.	REMARKS
26	5220424	*SWIVEL BEARING—Top ... ..	2	
	5038320	Boot ... ..	2	Up to B9405005
27	5043065	Boot ... ..	2	From B9405006
28	5038321	Spring clip ... ..	2	Superseded by 5039657
	5039657	Gaiter spring } Boot ... ..	2	Up to B9405005
29	5043367	Gaiter spring ... ..	2	From B9405006
30	9067056	Washer, 1/2" plain ... ..	2	
31	9552083	Nut, 1/2" UNF. Nyloc } Swivel bearing to axle carrier ... ..	2	
		*Note. It is important that the correct Boot and fixings are ordered, check illustrations.		
32	1207793	Circlip—Swivel bearing to upper link ... ..	2	
33	1208472	AXLE CARRIER, O/S (R.H.) ... ..	1	} Up to B94103418
	1208473	AXLE CARRIER, N/S (L.H.) ... ..	1	
	1229650	AXLE CARRIER, O/S (R.H.) ... ..	1	
	1229651	AXLE CARRIER, N/S (L.H.) ... ..	1	
34	5220425	†SWIVEL BEARING—Lower ... ..	2	
35	5038867	Boot ... ..	2	
36	5038866	Sleeve ... ..	2	} For use with Grooved Ball pin
37	5038868	Spring clip } Boot ... ..	2	
38	9067457	Washer ... ..	2	
	5042714	Boot ... ..	2	} For use with Non-Groove Ball pin
	5042715	Spring clip—Boot ... ..	2	
39	19504030	Plug ... ..	2	
40	9078072	Washer (Fibre)—Plug ... ..	2	
41	9540103	Nut, 3/8" UNF. slotted—Swivel bearing to axle carrier ... ..	2	
42	5220425	†SWIVEL BEARING—Lower ... ..	2	
	5038861	Boot ... ..	2	Up to B9405005
43	5043064	Boot ... ..	2	From B9405006
44	5038862	Spring clip } Boot ... ..	2	Superseded by 5039658
	5039658	Spring ring ... ..	2	Up to B9405005
	5043368	Spring ring ... ..	2	From B9405006
45	9803051	Plug ... ..	2	
46	9078072	Washer (Fibre)—Plug ... ..	2	
47	9540103	Nut, 3/8" UNF., slotted—Swivel bearing to axle carrier ... ..	2	
		†Note. It is important that the correct boot and fixings are ordered, check illustrations.		
48	9003222	Bolt, 1/2" UNF. x 3 3/8" } Swivel bearing ... ..	2	
49	9571083	Nut, 1/2" UNF. Nyloc } to lower link ... ..	2	
50	1214812	LOWER LINK, O/S (R.H.) } c/w Fulcrum pin ... ..	1	
	1214813	LOWER LINK, N/S (L.H.) } and bushes ... ..	1	
51		Lower link (Not supplied separately) ... ..		
52	1224224	Fulcrum pin } Lower ... ..	2	
53	5220479	Bush ... } link ... ..	4	
54	1205946	Washer, Special (Inner) ... } ... ..	4	
55	9067062	Washer, 1/2" plain (Outer) ... } Fulcrum pin ... ..	4	
56	9571083	Nut, 1/2" UNF. (Nyloc) ... } to bush ... ..	4	} Alternatives
	9553083	Nut, 1/2" UNF. (Philidas type) ... } ... ..	4	
57	P.108681	Clamp ... ..	4	
58	9003072	Bolt, 3/8" UNF. x 2" } Lower fulcrum pin ... ..	8	} Superseded by 9003246
	9003246	Bolt, 3/8" UNF. x 2 1/2" } to ... ..	8	
	9660241	Washer, 3/8" spring } front crossmember ... ..	8	
59	1207806	BUMP RUBBER—Lower Link ... ..	2	
	9664242	Washer, 3/8" shakeproof } Bump ... ..	2	
	5220703	Nut, 3/8" UNF. ... } rubber ... ..	2	
		BRAKES—See Brake Section.		

SUSPENSION — FRONT — From Series IV

Plate Ref.	Part Number	DESCRIPTION	No. per Veh.	REMARKS	
61	1218267	HUB c/w Road Wheel Bolts	2	} Plain	
62	1214407	Bolt—Road wheel ...	8		
63	1108015	Nut—Road wheel ...	8		
64	1201624	HUB, O/S (R.H.)	1		
	1201625	HUB, N/S (L.H.)	1		
65	9107088	"O" ring—Hubs	1		
66	1201405	Locknut, O/S (R.H.) "Ear"	1		
	1201406	Locknut, N/S (L.H.) type ...	1		
67	1206136	Locknut, O/S (R.H.) "Octagonal"	1		} Stamped "OFF"
	1206137	Locknut, N/S (L.H.) type ...	1		
		Note. When ordering check with illustrations.			
68	9192125	Inner bearing } Hub	2	Up to B94103418 From B94103419	
69	9192000	Outer bearing } Hub	2		
70	1201538	Distance piece } Inner bearing	2		
	1229441	Distance piece } Inner bearing	2		
71	P.49376	Oil seal ...	2		
72	P.116252	Lock washer ...	2		
73	9540100	Nut, 5/8" UNF. slotted } carrier	2		
74	1206169	Hub cap—Standard road wheels	2		
75	1206258	STEERING ARM, O/S (R.H.)	1		
	1206259	STEERING ARM, N/S (L.H.)	1		
	19107143	Bolt, 7/16" UNF. x 1 1/4" } Steering arm	2		
	9664282	Washer, 7/16" shakeproof } to carrier	2		
	19107153	Bolt, 7/16" UNF. x 1 1/8" } Steering arm and	2		
	9664282	Washer, 7/16" shakeproof } caliper to carrier	2		
76	1210241	STABILIZER BAR	1		
77	1210242	Bush—Stabilizer bar	4		
78	1210243	Clip—Bush	4		
	19506071	Screw, 3/8" UNF. x 7/8" } Clip to	4		
	9067244	Washer, 3/8" plain } lower link	2		
	5200486	Washer, 3/8" spring } lower link	4		
	5220703	Nut, 3/8" UNF. ... } lower link	4		
79	5220811	SHOCK ABSORBER	2	Up to intro. 5221220 From B395003873	
	5221220	SHOCK ABSORBER	2		
80	5038875	Rubber washer	4		
81	K.25676	Mounting washer—Inner	2		
82	5038876	Mounting washer—Outer	4		
83	5220703	Nut, 3/8" UNF.	2		
84	9520060	Locknut, 3/8" UNF.	2		
85	9123800	Mounting rubber—Lower eye	4		
		Note. A replacement Shock Absorber is available in part exchange for the original.			
86	9087157	Distance tube	2		
87	5220688	Bolt, 3/8" UNF. x 1" } Shock absorber to	2		
88	9660241	Washer, 3/8" spring } mounting bracket	2		
89	5220703	Nut, 3/8" UNF. ... } mounting bracket	2		
90	1207591	Mounting bracket—Shock absorber	2		
	P.106446	Bolt, Special	4		
	9664242	Washer, 3/8" shakeproof } Mounting bracket to spring pan	4		
	9510063	Nut, 3/8" UNF. ... } Mounting bracket to spring pan	4		